

DRAWING

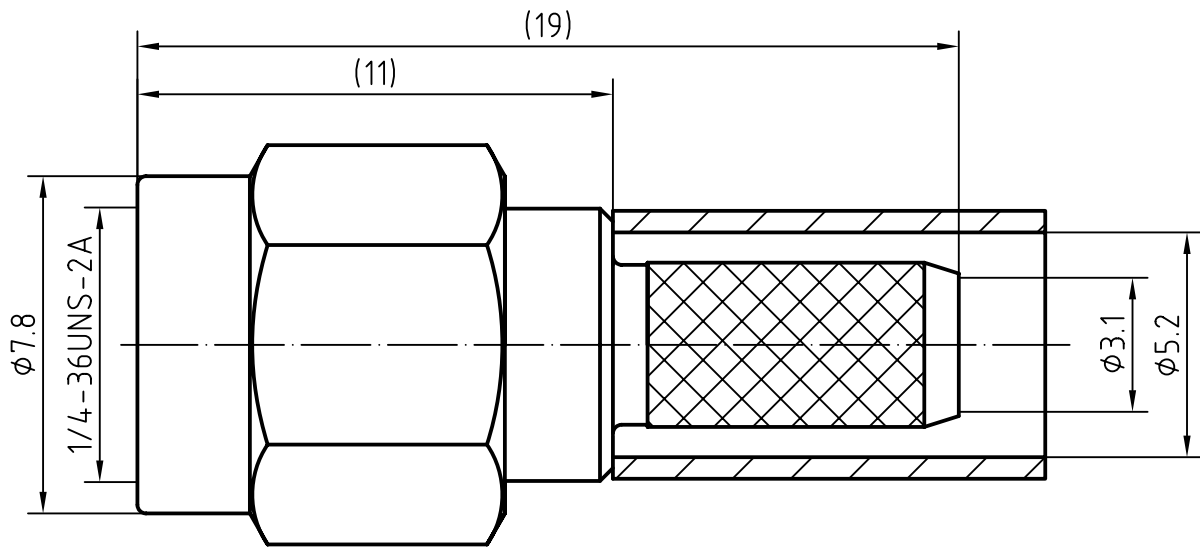

CABLE(RG58/U,RG303/U)

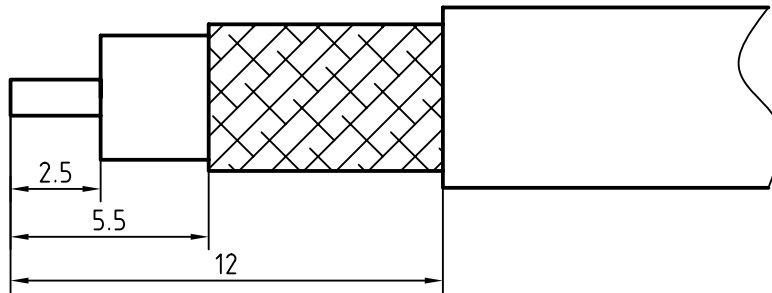

6	1	Crimp ferrule	Coper alloy/Nickel	
5	1	O ring	Silicon ruber	
4	1	Coupling nut	Brass/Gold plated	
3	1	Body	Brass/Gold plated	
2	1	Insulator	PFTE	
1	1	Center contact	Brass/Gold plated	
Itemref	Quantity	Title/Name, designation, material, dimension etc		Article No./Reference

Designed by	Checked by	Approved by - date	File name	Date	Scale
-------------	------------	--------------------	-----------	------	-------

19060602

MRO Electronic Supply Ltd

Male SMA RG58

Edition Sheet

CHARACTERISTICS

DESCRIPTION: SMA male connector

Electrical data:

Impedance:	50 ohm
Frequency range:	DC to 12.4 GHz
VSWR:	$\leq 1.08 + 0.03 \times f$ [GHz], DC to 6 GHz
Insertion loss:	$\leq 0.05 \times \sqrt{f}$ [GHz] dB
Insulation resistance:	$\geq 5000\text{M}\Omega$
Test voltage:	1000 V rms
Working voltage:	500 V rms
Contact resistance:	
1). Centre contact:	3.0 m Ω
2). Outer conductor:	2.0 m Ω
Power handling (at 20 °C, sea level, VSWR 1.0)	≤ 200 W @ 2 GHz;
RF-leakage	≥ 100 dB up to 1 GHz

- Limitations are possible due to the used cable type -

Environmental data:

Temperature rating:	-65 °C to 165 °C
2002/95/EC (RoHS):	Compliant

Mechanical data:

Mating cycles:	≥ 500
Coupling nut retention	≥ 270 N
Coupling test torque:	≤ 1.7 Nm
Recommended torque:	0.8 Nm to 1.1 Nm

Suitable cables:

RG58/U, RG303/U



19060602

MRO Electronic Supply Ltd

SMA Male RG58